



Joey Brinkoetter, REALTOR

Office: (217) 875-0555

Mobile: (217) 853-8087

Email: joey@brinkoetter.com

Web: www.brinkoetter.com



**2125
RESERVE
WAY**

DECATUR, IL

See more at **brinkoetter.com**



About This Property

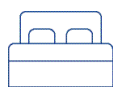

4 Beds



4.5 Baths



6,372 Sqft

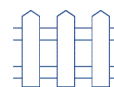

0.90 Acres



3 Car Garage

THE PROPERTY DETAILS

Welcome to a home that blends comfort with function in a beautifully maintained neighborhood. This spacious residence offers four bedrooms and four and a half bathrooms, giving everyone plenty of room to stretch out—or hide out when needed. The open-concept kitchen is designed for those who appreciate both form and flavor, featuring granite countertops, a large island, warming and cooling drawers, a built-in espresso machine, and even a dedicated coffee bar for those early starts or late-night chats. Walk downstairs and you'll find a walkout basement that's ready for guests or your next movie night. Complete with a full bar, wine cellar, and plenty of space to entertain or unwind, it's the kind of basement that could make you forget what the upstairs looks like. Not to be outdone, the outdoor

space includes a three-car garage, a built-in grill, and a luxurious inground pool ideal for warm-weather fun or pretending you're on vacation every weekend. The home's layout includes a spacious primary bedroom with a private bath, adding an extra touch of retreat at the end of the day. The neighborhood itself offers a quiet, welcoming atmosphere with a sense of community that's hard to find and easy to love. Whether you're hosting a holiday dinner, relaxing by the pool, or enjoying a quiet evening with a glass from your personal wine cellar, this home offers something for every lifestyle.



Joey Brinkoetter, REALTOR

Office: (217) 875-0555

Mobile: (217) 853-8087

Email: joey@brinkoetter.com

Web: www.brinkoetter.com



THE PROPERTY FLOOR PLAN

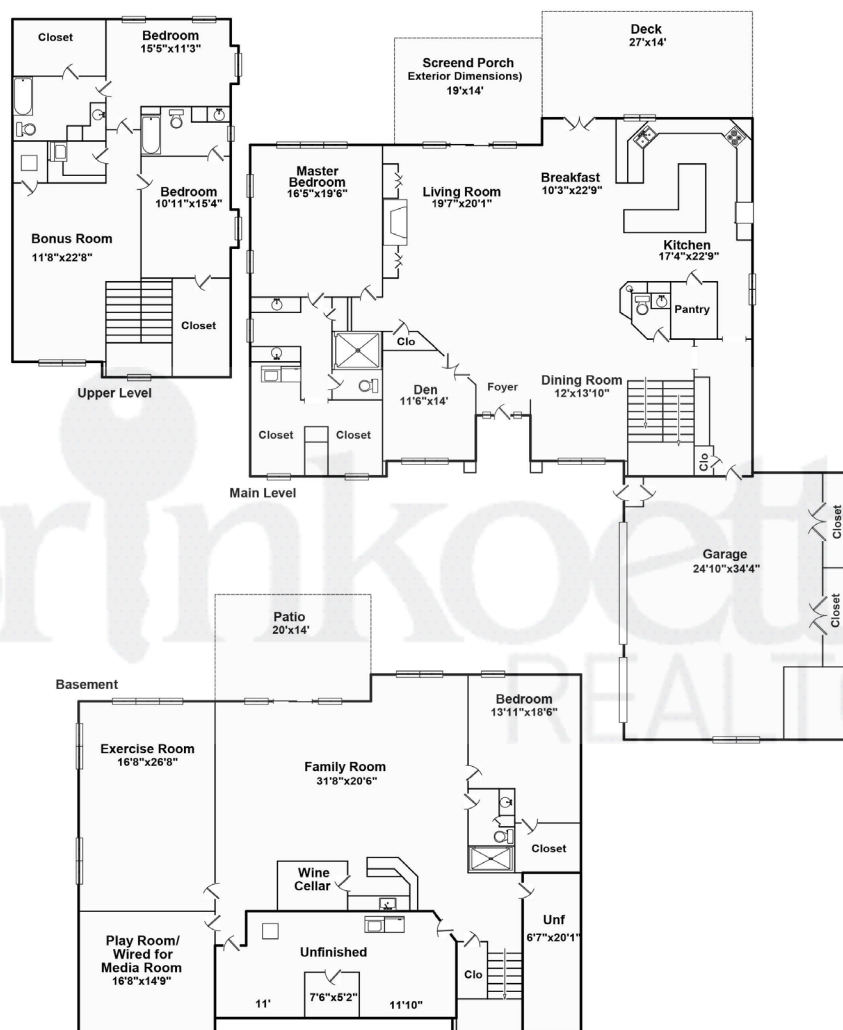

Area:	Sq. Ft.
Main Level	2,797
Upper Level	1,303
Fin. Basement	2,272
Unf. Basement	568
Garage	1,007
Deck	378
Screened Porch	266
Patio	280